

PLAN COFRAJ CAMIN TIP 27

SECTIUNEA 1-1

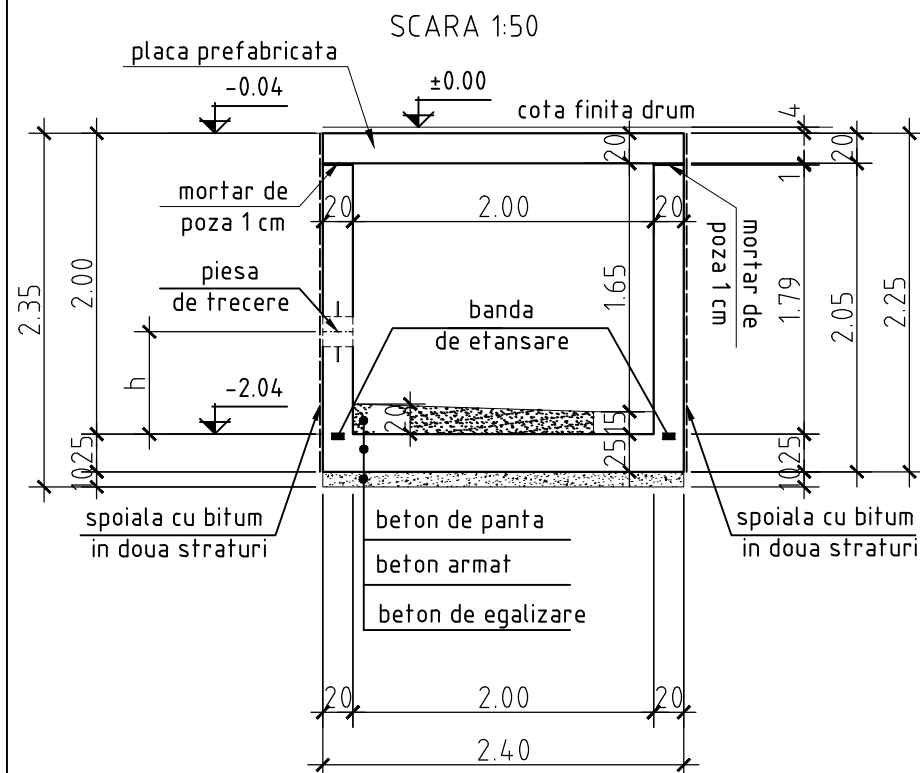

SECTIUNEA 2-2

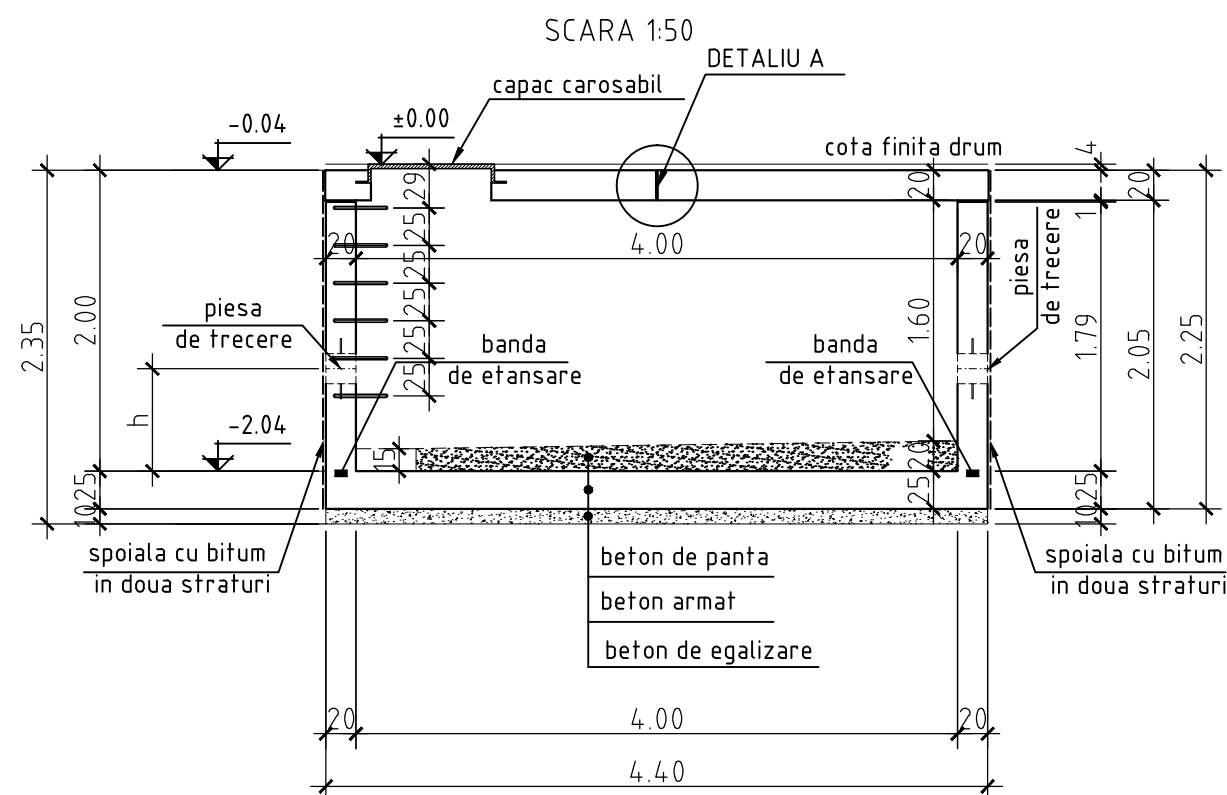

PLAN COFRAJ ANSAMBLU CAPAC PREFABRICAT

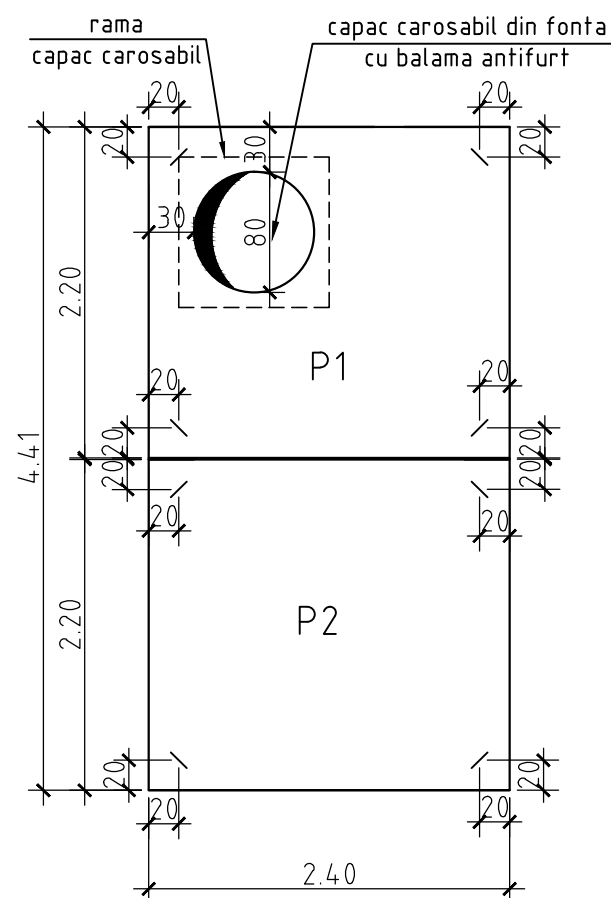

SECTIUNE ORIZONTALA

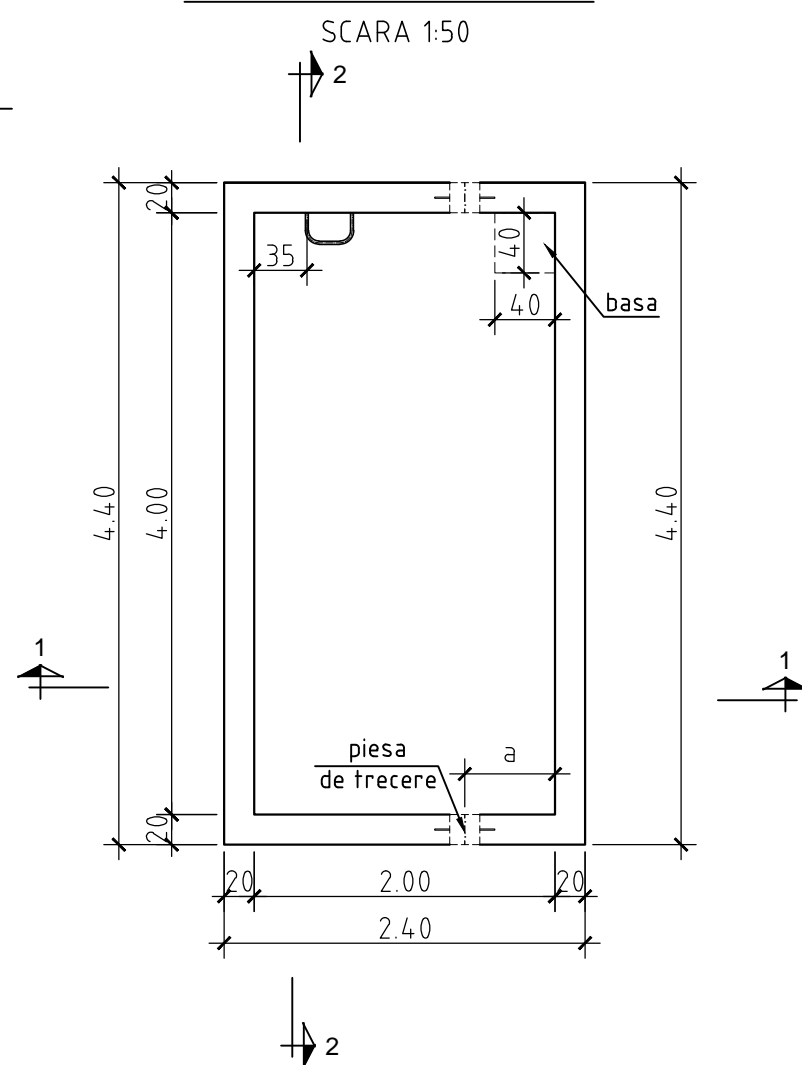

DETALIU A

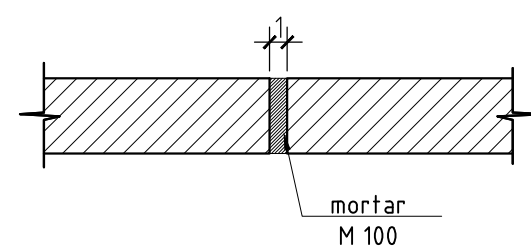

Rev	Nume	Ver	Aprb	Data	Descriere

Autoritatea contractanta: **S.C.AQUACARAS S.A. CARAS SEVERIN**



Adresa: P-la Republicii, nr. 7, Resita
Jud. Caras Severin
Tel.: +40 255 212 458
Fax.: +40 255 214 421
E-mail: office@aquacaras.ro

Proiectant: **Consortiu S.C Eptisa Romania S.R.L. si Eptisa Servicios de Ingenieria S.L.**
Sos. Dudesti-Pantelimon nr. 42, RAMS center, et. 5, corp A, sector 3, Bucuresti
Tel: +40 21 301 14 70
Fax: +40 21 301 14 80
www.eptisa.com



Proiect: **MODERNIZAREA INFRASTRUCTURII DE APA SI APA UZATA IN JUDETUL CARAS SEVERIN - AGLOMERAREA RESITA**

Plansa:

**Rețele apa
Camin tip 27-Plan Cofraj**

Desenat: Ing. B. Paraschiv	Data: Feb. 2013
Verificat: Ing. M. Serbanoiu	Data: Feb. 2013
Aprobat: Ing. D. Spiridon	Data: Feb. 2013

Plansa nr. CS-RE-PT/DA-A-R-27.1	Revizia 0
--	------------------

Scara plansa: 1 :50